

紫外大功率 LED 3535 系列

UV Power LED 3535 series



特性 Features :

- 高亮度，高发光效率

High Luminance, high illuminant Efficiency

- 功率等级：1~1.5W

Power: 1~1.5W

- 可靠性高，支持表面贴装技术

Good Reliability, Support for SMT

白光器件事业部-研发部 Development Center		
制定 DRAW	审核 CHECK	批准 APPROVE
日期 DATE:2016-08-31		

产品描述 PRODUCT DESCRIPTION

本产品主要作为工业紫外固化和一般的紫外应用，如诱虫、辨伪、美甲等，广泛应用于各类使用表面贴装结构的电子产品中。

This product is generally used as industrial UV curing and general UV applications, such as attracting insects, distinguishing, nail-phototherapy etc, used widely in various types of surface-mount construction of electronic products.

客户 Customer :	
客户产品代码 Customer P/N:	
审核 CHECK	批准 APPROVE
日期 DATE:	

目录 Catalogue

1.外形尺寸 Outline Dimensions	1
2.参数 Characteristics.....	2
3.典型特性曲线 Typical Characteristic Curves.....	3
4.可靠性实验 Reliability Test Items And Conditions	5
5.包装 Packaging	6
6.焊接指导 Guideline for Soldering.....	8
7.使用注意事项 Precautions	10
附录：分档标准 Appendix：Ranking Criteria	13

* 产品规格如因工艺改进而有所改变，恕不另行通知。

*The Specifications of the product may be modified for improvement without notice.

1.外形尺寸 Outline Dimension

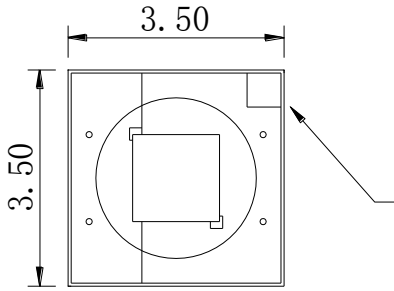

此处方块表示负极
Squares Represent The Cathode

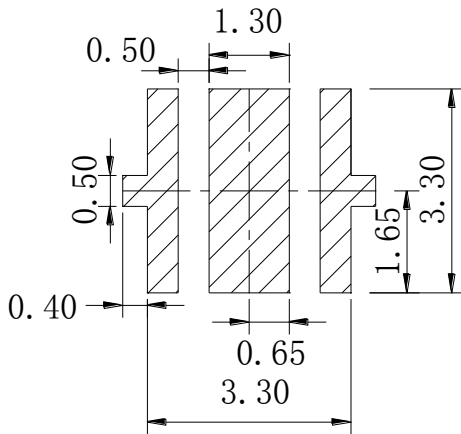
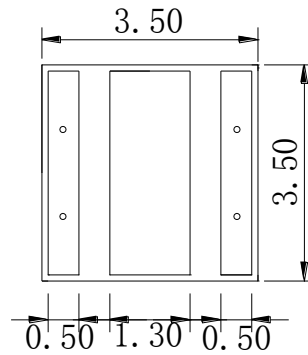
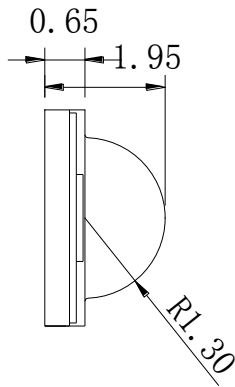

PCB焊盘参考尺寸
Recommended PCB Solder Pad

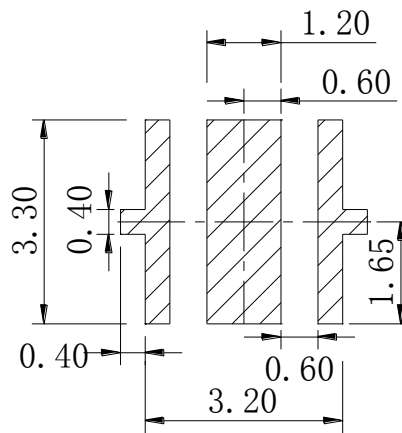

焊盘钢网参考开孔尺寸 (阴影区域镂空)
Recommended Stencil Pattern
(Hatched Area Is Opening)

单位: mm, 未注公差: ± 0.1 mm

All dimensions in mm, tolerances unless mentioned is ± 0.1 mm

2. 参数 Characteristics

光电参数 (Ta=25℃) Electro-Optical Characteristics (Temperature=25℃)

参数名称 Parameter	符号 Symbol	条件 Condition	型号 TYPE	最小值 MIN	典型值 Typ.	最大值 Max.	单位 Unit	备注 Note
正向电压 Forward Voltage	V _F	I _F =350mA	-		3.3		V	分档测试电流 Ranking test current I _T =350mA
反向电流 Reverse Current	I _R	V _R =5V	-	-	-	10	μA	-
峰值波长 Peak wavelength	λ _p	I _F =350mA	-	395		405	nm	
光功率 Radiometric	Φ _e	I _F =350mA	-		500		mW	分档测试电流 Ranking test current I _T =350mA
视角 View Angle	2θ _{1/2}	I _F =350mA	-	110	120	130	deg.	-
热阻 Thermal Resistance	R _θ	-	-	-	12	-	℃/W	-

注：①电压测试误差±0.1V；光功率测试误差±10%；峰值波长测试误差±1

Note : The above radiometric measurement allowance tolerance is ±10% , forward voltage measurement allowance tolerance is ±0.1V.
peak wavelength measurement allowance tolerance is ±1 ;

极限参数 (温度=25℃) Absolute Maximum Ratings (Temperature=25℃)

参数名称Parameter	符号Symbol	数值Rating	单位Unit
正向电流 Forward Current	IF	500	mA
正向脉冲电流* Pulse Forward Current*	IFP	700	mA
反向电压 Reverse Voltage	V _R	5	V
极限功耗 Limit power	Pd	1.8	W
抗静电能力 Electro-Static discharge	ESD(HBM)	4000	V
工作温度 Operating Temperature	T _{OPR}	-30 ~ +85	℃
贮存温度 Storage Temperature	T _{stg}	-40 ~ +100	℃
结点温度 Junction Temperature	T _j	125	℃
焊接温度 Solder Temperature	T _{sol}	回流焊 Reflow Soldering: 260℃ for 10 sec. 手工焊接 Hand Soldering: 350℃ for 3 sec.	

* 注: 脉冲宽度≤0.1ms, 占空比≤1/10

* Note: Pulse width≤0.1ms, Duty≤1/10

3.典型特性曲线 Typical Characteristics Curves

伏安特性曲线
Volt-Ampere Characteristic

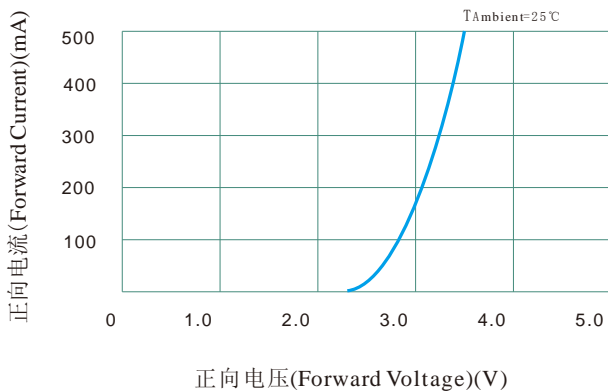

发光强度随电流变化特性曲线
Luminous Intensity VS. Forward Current

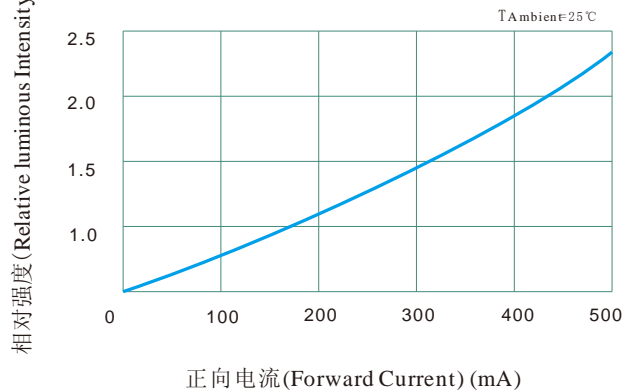

光通量维持率随时间变化曲线
Luminous Flux Maintenance VS Time

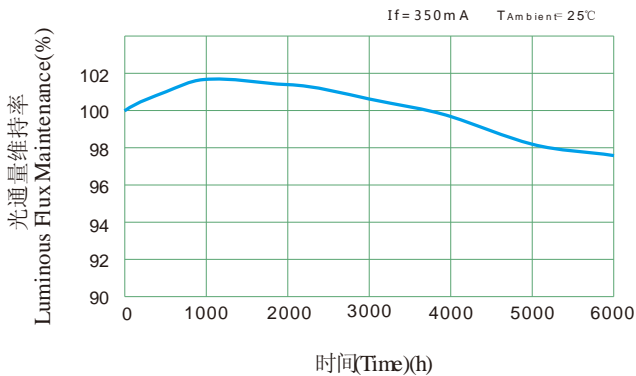

光通量维持率随使用温度曲线
Luminous Flux Maintenance Vs Temperature

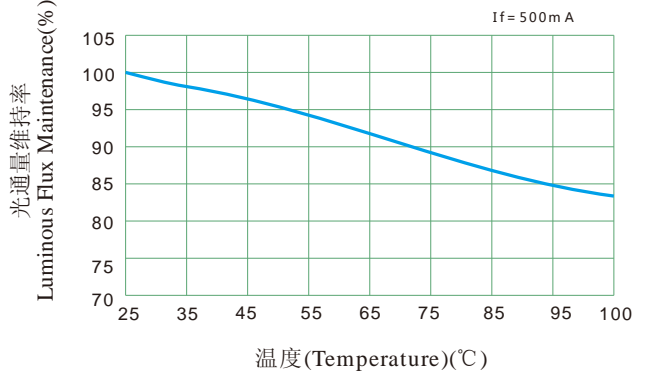

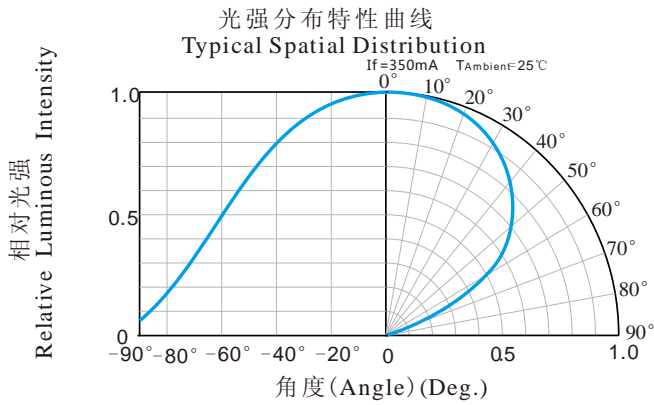
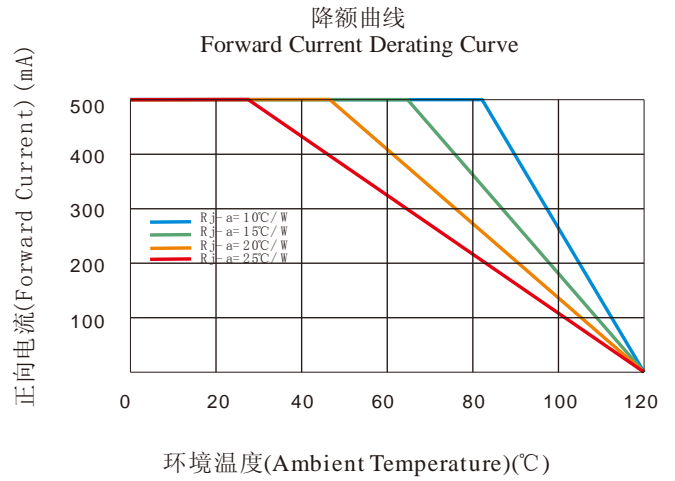
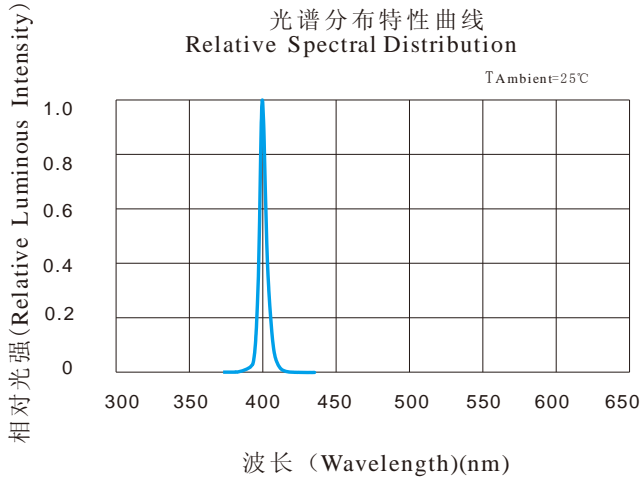

4.可靠性试验 Reliability Test Items And Conditions

实验项目 Test Items	参考标准 Reference	实验条件 Test Conditions	时间 Time	样品数 Quantity	判据 Criterion
冷热冲击 Thermal Shock	MIL-STD-202G	-40(30min)←→100°C (30min)	100 cycles	22	0/22
湿热循环 Temperature And Humidity Cyclic	JEITA ED-4701 200 203	-10°C ~ 65°C , 0% ~ 90%RH 24hrs./1cycle	10 cycles	22	0/22
高温储存 High Temperature Storage	JEITA ED-4701 100 103	Ta=85°C , RH=85%	1000h	22	0/22
低温储存 LowTemperature Storage	JEITA ED-4701 200 202	Ta=-40°C	1000h	22	0/22
高温高湿储存 High Temperature High Humidity	JEITA ED-4701 100 103	Ta=60°C , RH=90%	1000h	22	0/22
高温寿命 High Temperature Life Test	JESD22-A108D	Ta=85°C IF =10mA	1000h	22	0/22
常温寿命试验 Life Test	JESD22-A108D	Ta=25°C	1000h	22	0/22
耐焊接热 Resistance to Soldering Heat	GB/T 4937, II, 2.2&2.3	Tsol*=(240±5)°C 10secs	2 次 2 times	22	0/22

失效判断标准 Criteria For Judging Damage:

测试项目	符号	测试条件	判定标准
正向电压 Forward Voltage	V _F	I _F = I _{FT}	初始值±10% Initial Data±10%
反向电流 Reverse Current	I _R	V _R = 5V	I _R ≤ 10μA
光功率 Radiometric	Φ _e	I _F = I _{FT}	平均Φ _e 衰减 ≤ 30% , 单个Φ _e 衰减 ≤ 50% Average Φ _e degradation ≤ 30%; Single LED Φ _e degradation ≤ 50%
耐焊接热 Resistance to Soldering Heat		Tsol = 260 °C	材料无内部裂痕、无材料间爆裂、剥离、无死灯。 Material without internal cracks , no material between stripped , no deaded light.

5.包装 Packaging

(1)载带 Carrier Tape

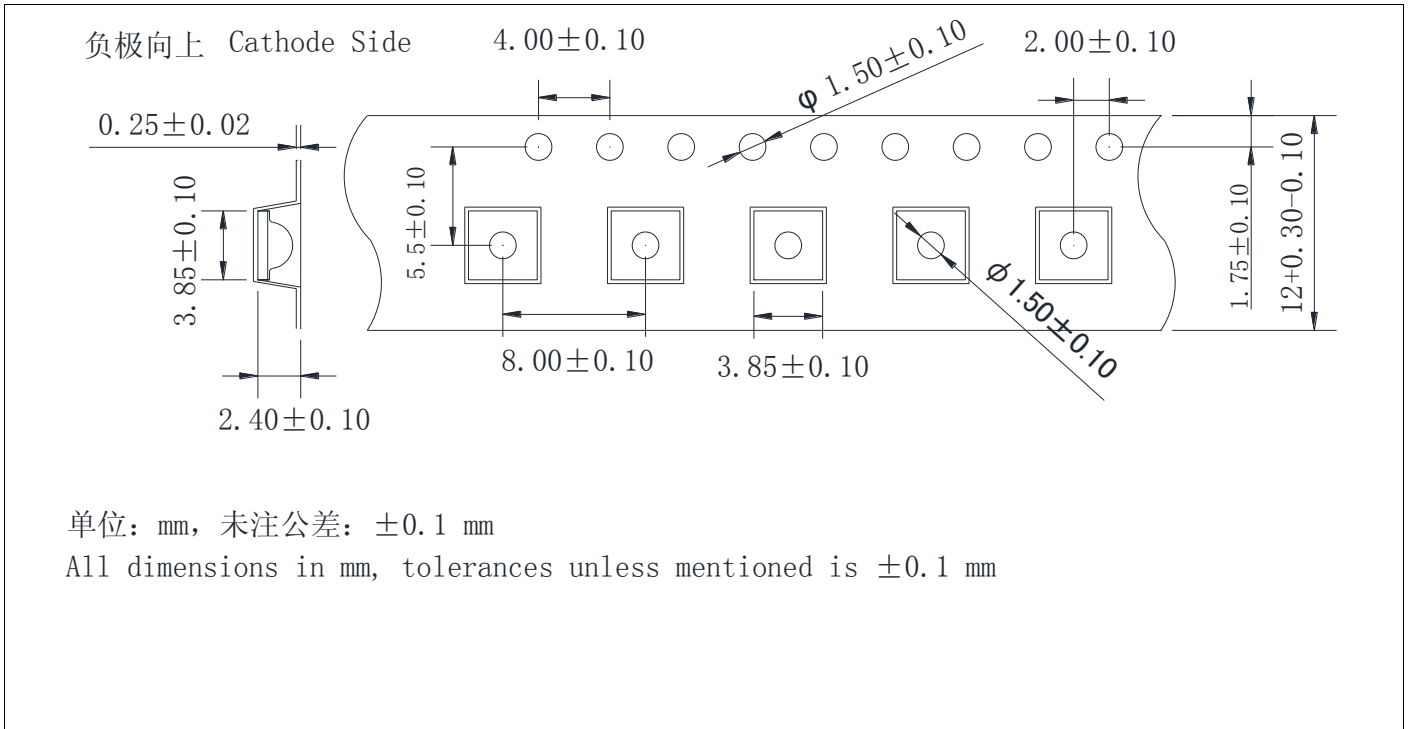

(2)编带细节 Details Of Carrier Tape

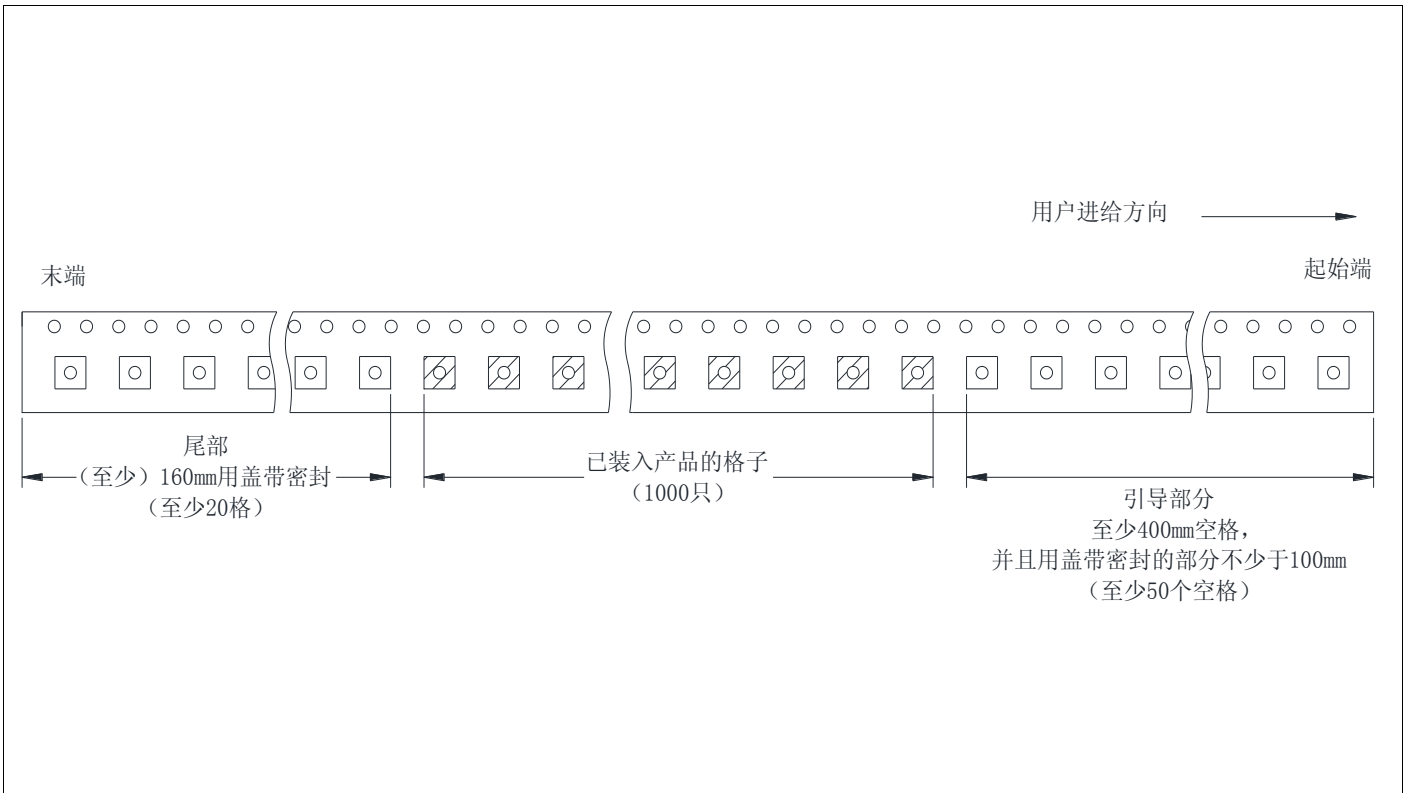

(3)带盘 Reel Dimension

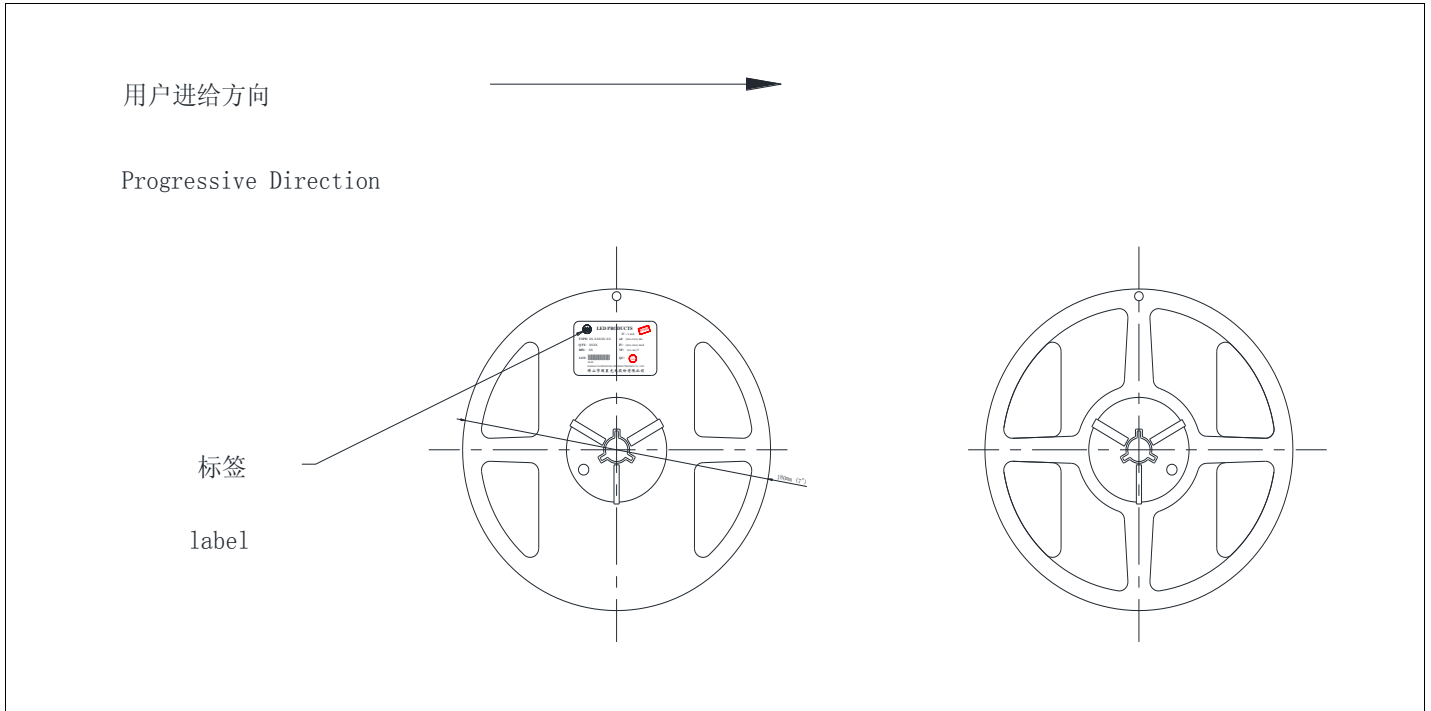

(4)防潮抗静电包装 Moisture Proof and Anti- Electrostatic Foil Bag

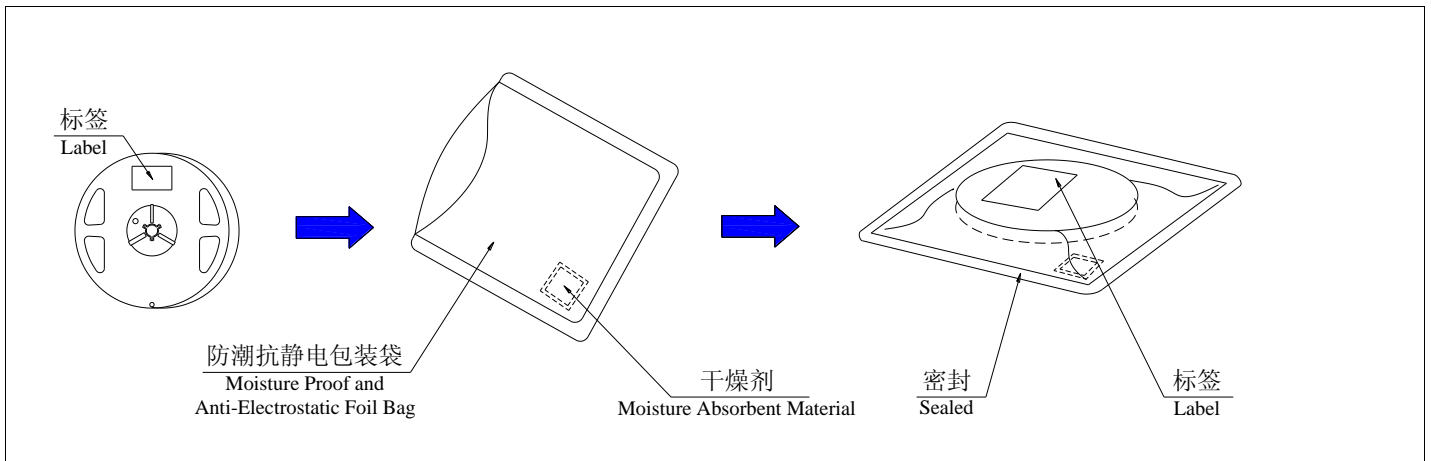

(5)标签说明 Label Explanation

TYPE : 产品型号 Product model
 QTY : 数量 Quantity
 BIN : 分档 Rank
 SC : 生产编码 Production code
 LOT : 批号 Lot Number
 P : 光功率范围 Radiometric
 VF : 正向电压范围 Forward Voltage
 IF : 测试电流 Test Current



High Power LED IF(mA) = xxx

TYPE: **FP-3535UV-BC-CS**

QTY: xxx pcs λP(nm): xxx

BIN: xxx VF (V): xxx

SC: xxx QC:

LOT: xxxxx

FOSHAN NATIONSTAR OPTOELECTRONICS CO.,LTD
 佛山市国星光电股份有限公司

6. 焊接指导 Guideline for Soldering

(1) 回流焊接：推荐使用以下无铅回流焊接温度图进行。

Reflow Soldering: Use the conditions shown in the under Figure of Pb-Free Reflow Soldering.

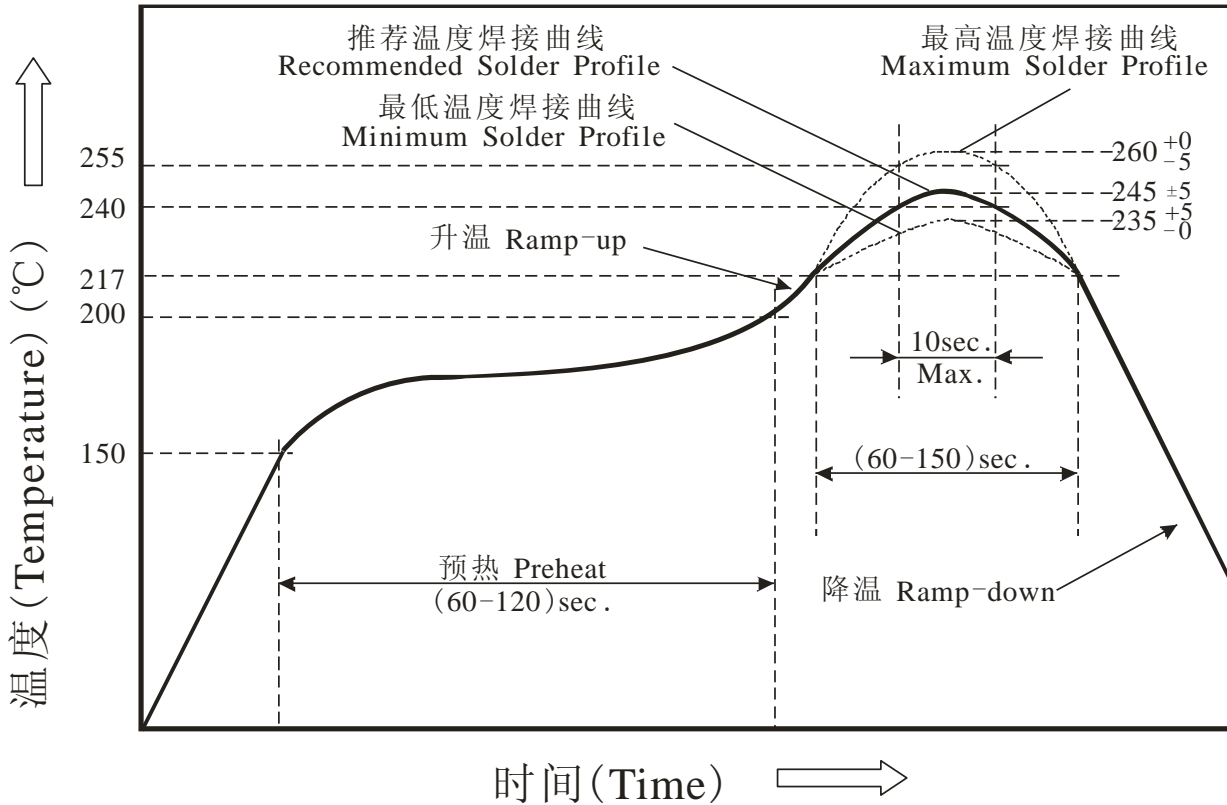

- 回流焊接最多只能进行两次。

Reflow soldering should not be done more than two times.

- 在回流焊接升温过程中，请不要对 LED 施加任何压力。

Stress on the LEDs should be avoided during heating in soldering process.

- 在焊接完成后，待产品温度下降到室温之后，再进行其他处理。

After soldering, do not deal with the product before its temperature drop down to room temperature.

(2)清洗 Cleaning

在焊接后推荐使用酒精进行清洗，在温度不高于 30℃的条件下持续 3 分钟，不高于 50℃的条件下持续 30 秒。使用其他类似溶剂清洗前，请先确认使用的溶剂不会对 LED 的封装和环氧树脂部分造成损伤。

超声波清洗也是有效的方法，一般最大功率不应超过 300W，否则可能对 LED 造成损伤。请根据具体的情况预先测试清洗条件是否会对 LED 造成损伤。

It is recommended that alcohol be used as a solvent for cleaning after soldering. Cleaning is to go under 30℃ for 3 minutes or 50℃ for 30 seconds. When using other solvents, it should be confirmed beforehand whether the solvents will dissolve the package and the resin or not.

Ultrasonic cleaning is also an effective way for cleaning. But the influence of Ultrasonic cleaning on LED depends on factors such as ultrasonic power. Generally, the ultrasonic power should not be higher than 300W. Before cleaning, a pre-test should be done to confirm whether any damage to LEDs will occur.

* **注意：**此一般指导原则并不适用于所有 PCB 设计和焊接设备的配置。具体工艺受到诸多因素的影响，请根据特定的PCB设计和焊接设备来确定焊接方案。

* **Note:** This general guideline may not apply to all PCB designs and configurations of all soldering equipment. The technics in practice is influenced by many factors, it should be specialized base on the PCB designs and configurations of the soldering equipment..

7.使用注意事项 Precautions

(1)贮存 Storage

- 本产品使用密封防潮抗静电袋包装，并附有干燥剂，未开封的产品有一年的保存时间。

Moisture proof and anti-electrostatic package with moisture absorbent material is used, to keep moisture to a minimum.

- 开封前，产品须存放在温度不高于 30℃，湿度不高于 60%RH 的环境中。

Before opening the package, the product should be kept at 30℃ or less and humidity less than 60% RH, and be used within a year.

- 开封后，产品须存放在温度不高于 30℃，湿度不高于 60%RH 的环境中，且应该在 24 小时（1 天）内使用完。建议工作环境为温度不高于 30℃，湿度不高于 60%RH。

After opening the package, the product should be stored at 30℃ or less and humidity less than 60%RH, and be soldered within 24 hours (1 day). It is recommended that the product be operated at the workshop condition of 30℃ or less and humidity less than 60%RH.

- 对于尚未焊接的 LED，如果吸湿剂或包装失效，或者产品没有符合以上有效存储条件，烘焙可以起到一定的性能恢复效果。烘焙条件：(80±5)℃，持续 24 小时。

If the moisture absorbent material has fade away or the LEDs have exceeded the storage time, baking treatment should be performed based on the following condition: (80±5)℃ for 24 hours.

(2)静电 Static Electricity

静电和电涌会导致产品特性发生改变，例如正向电压降低等，如果情况严重甚至会损毁产品。所以在使用时必须采取有效的防静电措施。

所有相关的设备和机器都应该正确接地，同时必须采取其他防止静电和电涌的措施。

使用防静电手环，防静电垫子，防静电工作服、工作鞋、手套，防静电容器，都是有效的防止静电和电涌的措施。

Static electricity or surge voltage damages the LEDs. Damaged LEDs will show some unusual characteristics such as the forward voltage becomes lower, or the LEDs do not light at the low current., even not light.

All devices, equipment and machinery must be properly grounded. At the same time, it is recommended that wrist bands or anti-electrostatic gloves, anti-electrostatic containers be used when dealing with the LEDs.

(3)设计建议 Design Consideration

设计电路时，通过 LED 的电流不能超过规定的最大值，同时，还需使用保护电阻，否则，微小的电压变化将会引起较大的电流变化，可能导致产品损毁。

建议使用以下 (A) 电路，该电路能够很好的调节通过每个 LED 的电流；不推荐使用 (B) 电路，该电路在持续的电压驱动下，LED 的正向电压 (V_f) 发生变化，电流会随之而发生变化，可能使某些 LED 承受高于规定的电流值。

In designing a circuit, the current through each LED must not exceed the absolute maximum rating specified for each LED. In the meanwhile, resistors for protection should be applied, otherwise slight voltage shift will cause big current change, burn out may happen.

It is recommended to use Circuit (A) which regulates the current flowing through each LED rather than Circuit (B). When driving LEDs with a constant voltage in Circuit (B), the current through the LEDs may vary due to the variation in Forward Voltage (V_f) of the LEDs. In the worst case, some LED may be subjected to stresses in excess of the Absolute Maximum Rating.

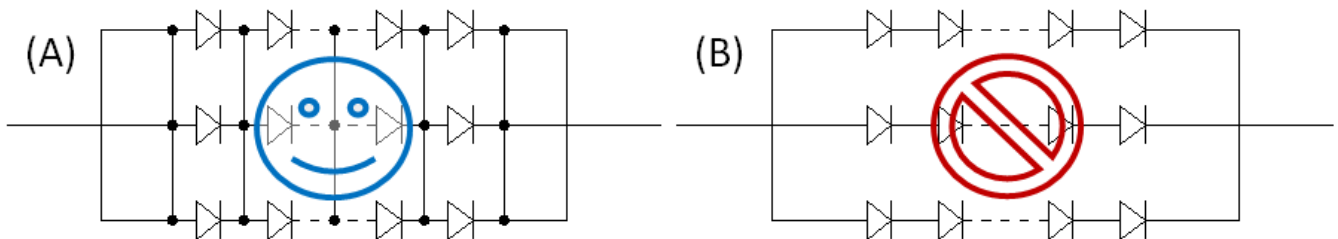

LED 的特性容易因为自身的发热和环境的温度的改变而发生改变。温度的升高会降低 LED 的发光效率、影响发光颜色等，所以在设计时应充分考虑散热的问题。

Thermal Design is paramount importance because heat generation may result in the Characteristics decline, such as brightness decreased, Color changed and so on. Please consider the heat generation of the LEDs when making the system design.

(4)其它事项 Others

直接用手拿取产品不但会污染透镜表面，也可能由于静电等因素导致产品性能的改变。过度压力会导致产品发生形变甚至损毁，特别是当产品处于高温状态下，应避免对产品施加过度压力。

When handling the LEDs, touching the lens with bare hands will not only contaminate its surface, but also affect on its optical characters. Excessive force to the product might result in catastrophic failure of the LEDs. For this reason, please do not put excessive stress on LEDs, especially when the LEDs are heated such as during Reflow Soldering.

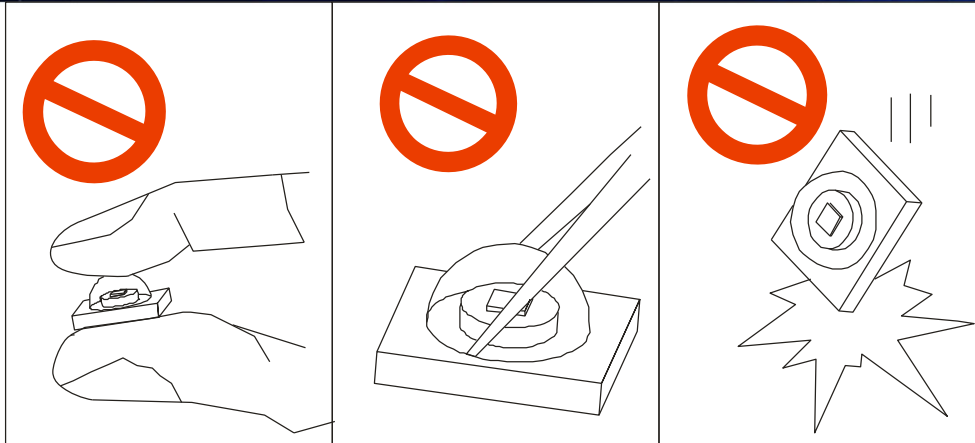

LED 的透镜相当脆弱，请勿用坚硬、尖锐的物体刮、擦透镜部分，避免造成透镜损坏或脱落。在用镊子夹取产品的时候也应当小心注意。

The lens of the product is fragile, so please avoid scratch or friction over the lens surface. While handling the product with tweezers, do not hold by the lens, be careful.

(5)眼睛保护忠告 Safety Advice For Human Eyes

LED 发光时，请勿直视发光光源，特别是对于一些光强较高的 LED，强光可能伤害你的眼睛。

Viewing direct to the light emitting center of the LEDs, especially those of great Luminous Intensity, will cause great hazard to human eyes. Please be careful.