

承认书

Approve Sheet

产品 /Product	LED
型号/Part Number	IE-3528B-ST-L-A01-Y
发行日期/Issue Date	
客户规格/customer specification	
客户/Customer	
光通量/亮度(Lm/mcd)	IV:600-800mcd
电压/VF (V)	VF: 3.0-3.4v
波长 (Wd)	WL:460-470nm
显色指数/CRI	
其他要求/other request	
备注/remarks	

■ Package Dimensions:

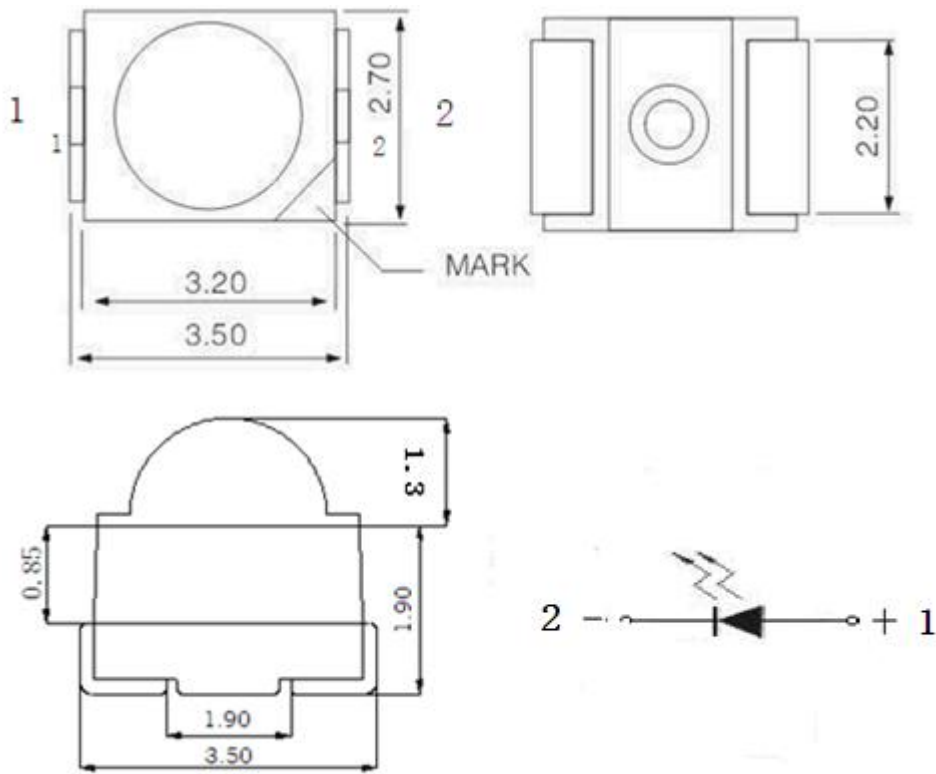

“小红帽” 系列



Notes

Tolerance is \pm
0.25mm (.010")

unless otherwise noted.

Protruded resin under flange is 1.0mm(.04") max.

Lead spacing is measured where the leads emerge from the package.

Specifications are subject to change without notice.

Absolute Maximum Ratings at TA=25

Parameter (参数)	Valce (标准值)	Unit (单位)
Power Dissipation (消耗功率)	60	mW
Peak Forward Current (脉冲顺向电流) (1/10 Duty Cycle, 0.1ms Pulse width)	50	mA
Continuous Forward Current (连续工作电流)	20	mA
Derating Linear From 50°C (电流比例关系)	0.4	mA/°C
Reverse Voltage (反向电压)	5	V
Test temperature (试验温度)	-40°C to +85°C	
Storage Temperature Range (储存温度)	-0°C to +40°C	
Lead Soldering Temperatur Δ (焊接温度) [4mm (.157") From Body] (焊接温度)	260°C for 5 Seconds	

Electrical / Optical Characteristics at TA=25°C

Parameter (参数)	Symbol	Min	Typ.	Max	Unit	Test Condition
wave length(λ_d)(波长)	Wd	460	--	470	nm	IF=20mA
Forward Voltage (R) (电压)	VF	3.0	3.2	3.4	V	
Viewing Angle(发光角度)	2 θ 1/2	50	--	60	deg	
Reverse Current(反向电流)	IR	--	--	5	μ A	VR=5V

Notes. Luminous intensity is measured with a light sensor and filter combination that approximates the CIE (Commission International De L'Eclairage) eye-response curve. 1/2 is the off-axis angle at which the luminous intensity is half the axial luminous and intensity. The dominant wavelength, λ_d is derived from the CIE chromaticity diagram and represents the single wavelength which defines the color of the device. The IV guarantee should be added $\pm 15\%$.

INTENSITY BIN LIMIT (IF=20mA)

Bin Code	Min(nm)	Max(nm)
A	460	465
B	465	470

Bin Code	Min(V)	Max(V)
A	3.0	3.2
B	3.2	3.4

Optical Characteristics

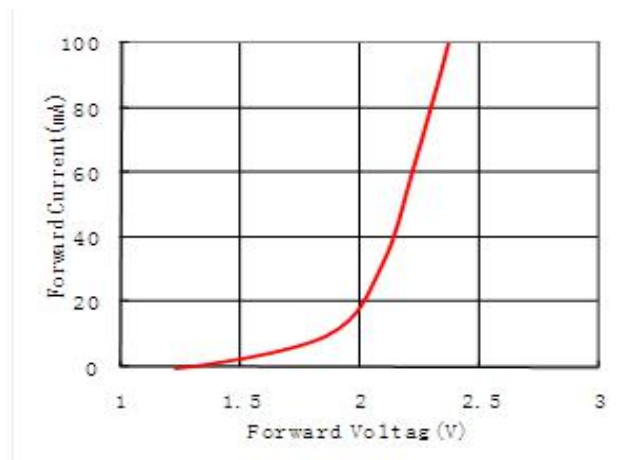
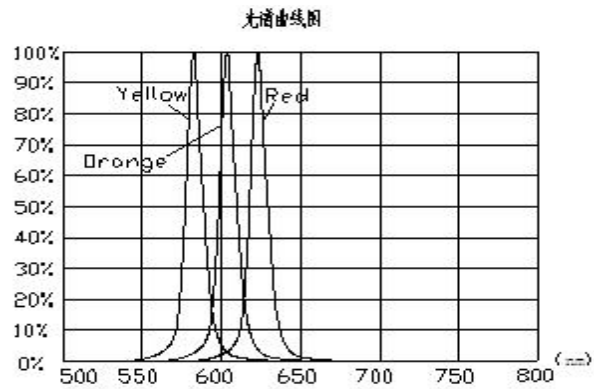

电流与温度关系曲线图

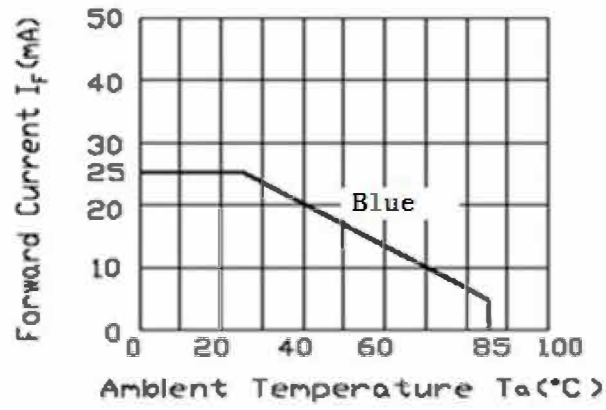

亮度/说明与温度的关系曲线图

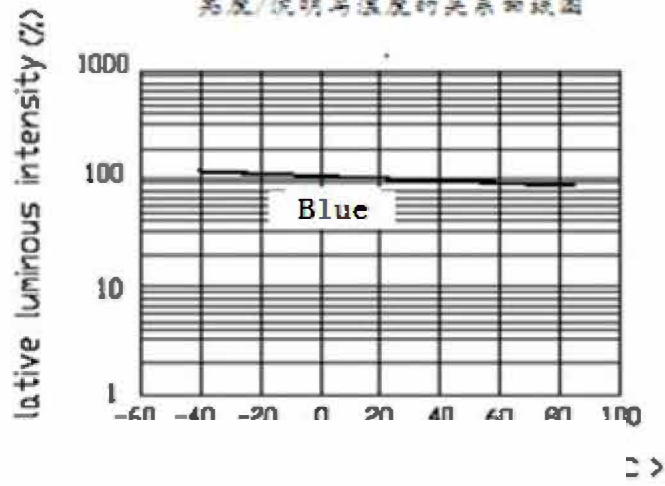

二 >

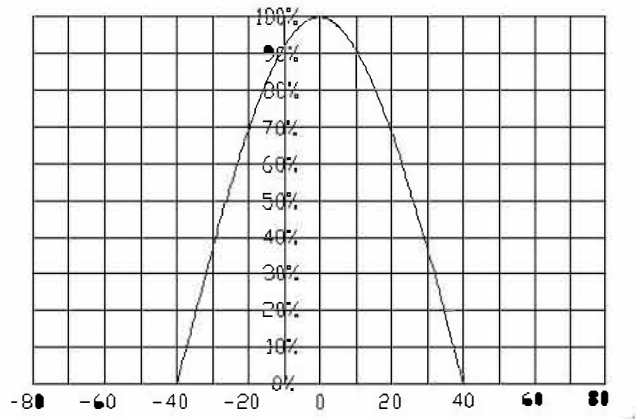

process to normal temperature is required between first and Second soldering process.

(本产品最多只可回焊两次,且在首次回焊后须冷却至室温之后方可进行第二次回焊.)

1>Lead Solder (有铅回焊)

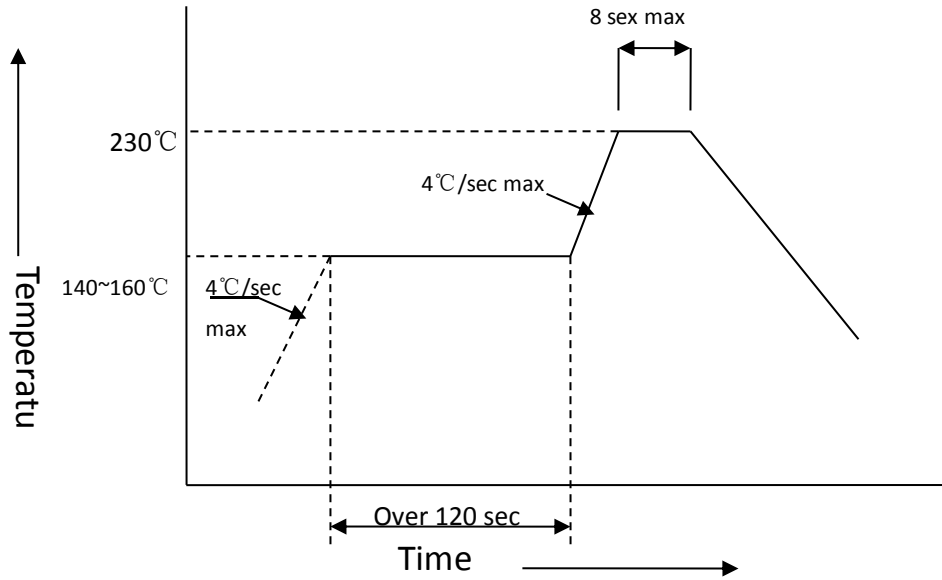

2>Lead-Free Solder(无铅回焊)

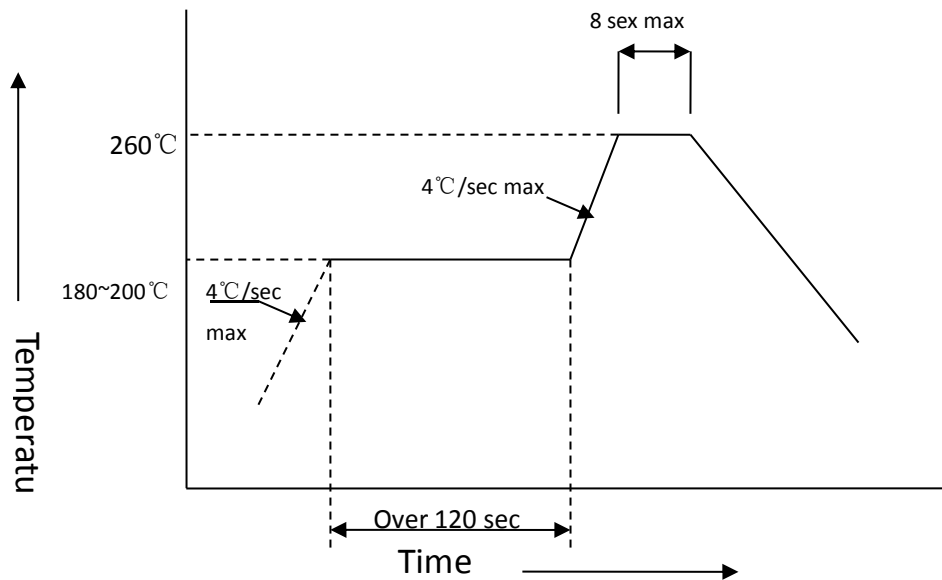

Recommended Soldering Patter (n推荐焊盘式样)

<Units:mm>(单位:毫米)

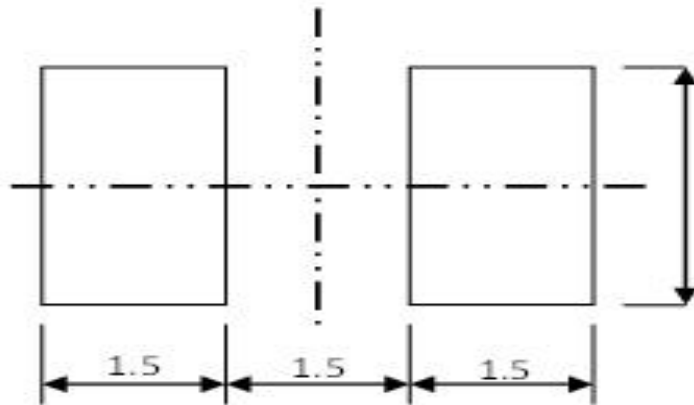

Method of Taping / Polarity and Orientation

Packing unit 2000/reel, $\varnothing 180$ mm

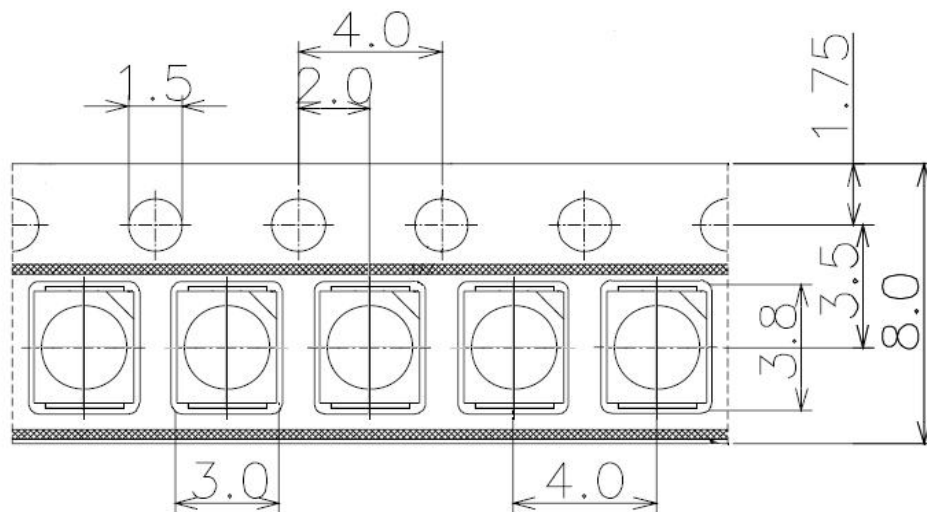

Adhesion Strength of Cover Tape : Adhesion strength to be 0.1 – 0.7N when the cover tape is turned off from the carrier at 10° angle to be the carrier tape. (盖带力度：当盖带与载带成10度角时力度为0.1 – 0.7N)